

CONQUER Fuse Holder

Specification Guide Codes:

A = Item Number

B = Rated Current

C = Insulation Resistance At 500 V DC

D = Contact Resistance

E = Dielectric Strength For 60 Seconds

- Insulating Body : Flame Retarding UL 94 V0 Thermoplastic Material.
- Contact: Nickel or Tin Plated Copper Alloy.

SPECIAL FUSE HOLDER

CQ-215 RoHS

For 10.3 x 38.1mm (5AG) Fuse

B: 30A 600V.
C: 100MΩ Min
D: 5mΩ At 1A DC
E: AC3000V Min.
Bayonet Knob
Approval:

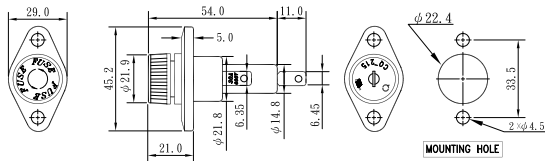

CQ-225 RoHS

For 10.3x38.1mm (5AG) Fuse

B: 30A 600V.
C: 100MΩ Min
D: 5mΩ At 1A DC
E: AC3000V Min.
Terminal Option:
Quick Terminal
Screw Driver Knob
Approval:

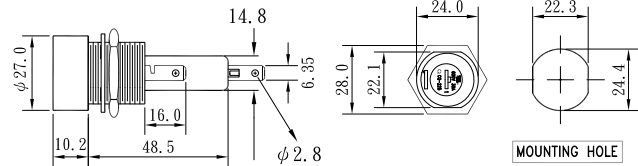

MET Fuse Holder

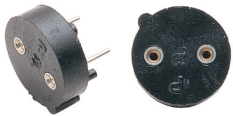

A. Housing : Glass filled polyester UL94-V0
B. Insulation Resistance : 103MΩ at V=100V
C. Temperature Range : -55°C to 125°C
D. Contact : Beryllium copper , Heat treated
E. Plating : Nickel / Tin
F. Max. Current Rating : 6.3A
G. Contact Resistance : <4mΩ
H. Insertion Force : <200g
I. Withdrawal Force : >50g

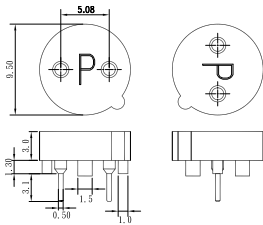

MST Fuse Holder



A. Housing : Glass filled polyester UL94-V0
B. Insulation Resistance : 103MΩ at V=100V
C. Temperature Range : -55°C to 125°C
D. Contact : Beryllium copper , Heat treated
E. Plating : Nickel / Tin
F. Current Rating : 3A
G. Contact Resistance : <4mΩ
H. Insertion Force : <250g
I. Withdrawal Force : >50g

